

Meadow Square

FOR MORE INFORMATION:

Adam Moschin
Vice President - Leasing
amochin@clarkstreet.com
T 312-377-9306



RESTAURANT / RETAIL OUTLOTS AVAILABLE ZONING: C-2 COMMERCIAL

- > Ideally situated at the heart of the "Downtown District" of Rolling Meadows and located less than ½ mile east of Interstate 290/State Route 53 (161,000 VPD).
- > New construction of 116 townhomes directly adjacent south of the site to commence Spring 2018.
- > Located caddy-corner to a newly renovated, strong performing, Jewel-Osco anchored shopping center.
- > Close proximity to Westgate Elementary, Carl Sandburg Junior High School and St. Colette schools.
- > Proximate to municipal facilities such as the state-of-the-art public library, City Hall, Station 15 of the Rolling Meadows Fire Department and Northwest Community Hospital along Kirchoff Road.
- > Utility services to be stubbed to site; access to offsite detention pond.

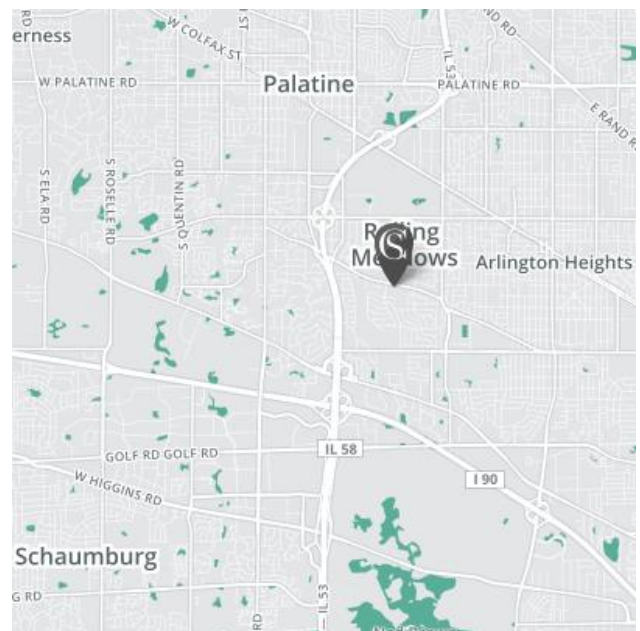

PROPERTY NAME:

Meadow Square

TOTAL POPULATION:

1 Mile - 11,974
3 Mile - 101,566
5 Mile - 294,192

AVERAGE HHI:

1 Mile - \$92,072
3 Mile - \$104,133
5 Mile - \$100,224

PHYSICAL ADDRESS:

SEC of Kirchoff Rd. & Meadow Dr., Rolling Meadows, IL

TOTAL BLDG SIZE/GLA:

Two 0.73-acre outlots available

Meadow Square ► SITE PLAN

Rolling Meadows, IL

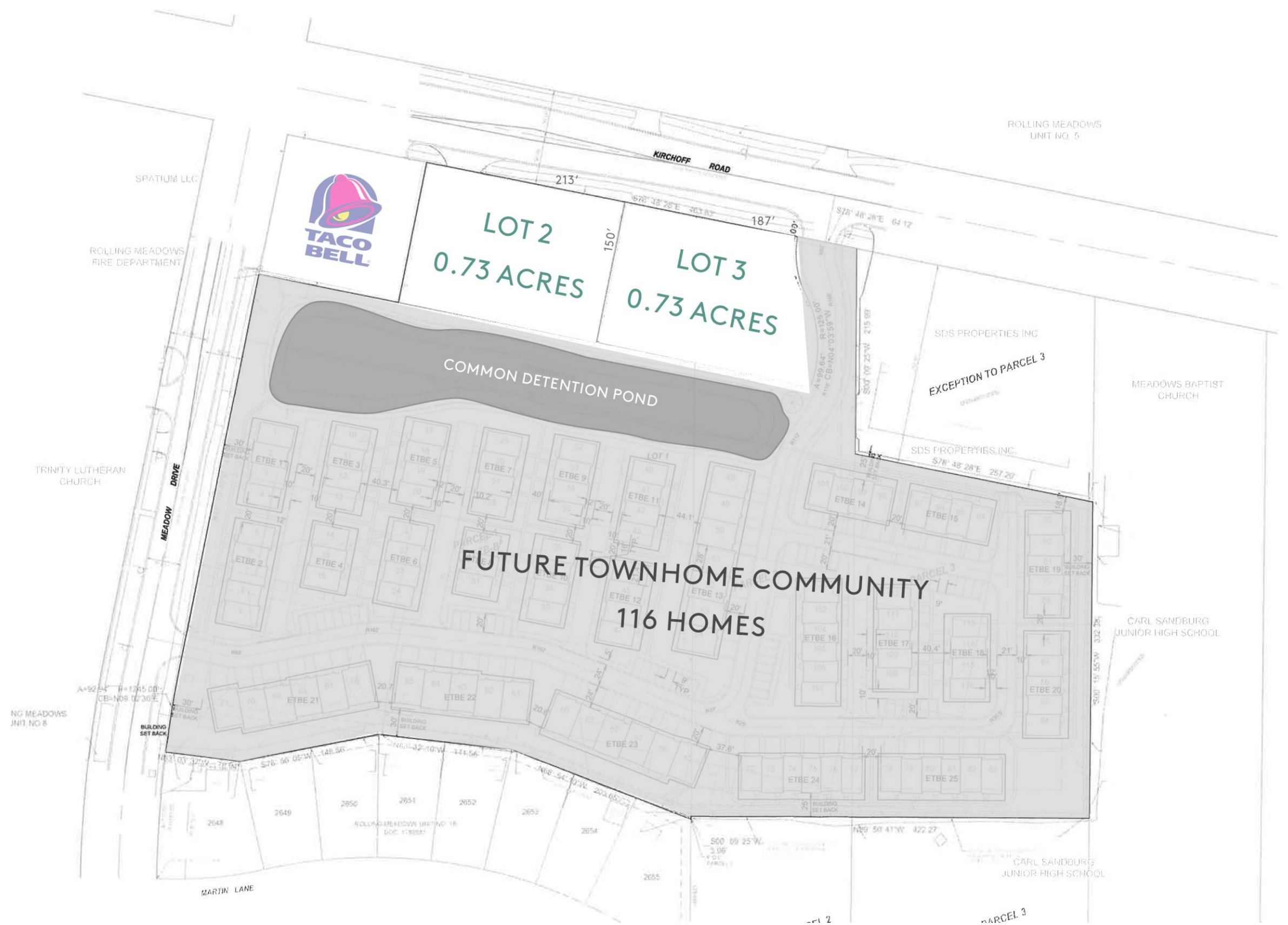

Meadow Square ► TRADE AERIAL

Rolling Meadows, IL



SUMMARY DEMOGRAPHIC PROFILE

Project: Meadow Square
Location: Rolling Meadows, IL



March 2017

	1 Mile Radius		3 Mile Radius		5 Mile Radius	
Population						
2022 Projection	11,974		101,566		294,192	
2017 Estimate	11,995		101,168		292,700	
2010 Census	12,020		100,253		289,910	
Households						
2022 Projection	4,703		41,378		118,533	
2017 Estimate	4,686		41,048		117,497	
2010 Census	4,635		40,281		115,380	
	Number	Percent	Number	Percent	Number	Percent
Population by Race	11,995	100.00%	101,168	100.00%	292,700	100.00%
White Alone	10,235	85.33%	82,494	81.54%	219,890	75.12%
Black or African American Alone	128	1.07%	1,634	1.62%	6,551	2.24%
American Indian and Alaska Native Alone	21	0.18%	203	0.20%	774	0.26%
Asian Alone	575	4.79%	10,541	10.42%	38,923	13.30%
Native Hawaiian and Other Pacific Islander Alone	3	0.03%	18	0.02%	64	0.02%
Some Other Race Alone	741	6.18%	3,910	3.86%	19,276	6.59%
Two or More Races	292	2.43%	2,369	2.34%	7,222	2.47%
Population Hispanic or Latino	11,995	100.00%	101,168	100.00%	292,700	100.00%
Hispanic or Latino	2,012	16.77%	12,498	12.35%	45,852	15.67%
Not Hispanic or Latino	9,983	83.23%	88,670	87.65%	246,848	84.33%
Households by Income	4,686	100.00%	41,048	100.00%	117,497	100.00%
< \$15,000	247	5.27%	2,592	6.31%	7,041	5.99%
\$15,000 - \$24,999	328	7.00%	2,800	6.82%	8,063	6.86%
\$25,000 - \$34,999	267	5.70%	2,799	6.82%	8,559	7.28%
\$35,000 - \$49,999	629	13.42%	4,437	10.81%	13,668	11.63%
\$50,000 - \$74,999	905	19.31%	6,929	16.88%	21,396	18.21%
\$75,000 - \$99,999	747	15.94%	5,823	14.19%	16,446	14.00%
\$100,000 - \$124,999	571	12.19%	4,538	11.06%	13,020	11.08%
\$125,000 - \$149,999	354	7.55%	3,149	7.67%	8,461	7.20%
\$150,000 - \$199,999	327	6.98%	3,759	9.16%	9,898	8.42%
\$200,000 - \$249,999	153	3.27%	1,728	4.21%	4,471	3.81%
\$250,000 - \$499,999	123	2.62%	1,881	4.58%	4,862	4.14%
\$500,000+	34	0.73%	615	1.50%	1,612	1.37%
Households by Tenure	4,686	100.00%	41,048	100.00%	117,497	100.00%
Owner Occupied	4,063	86.71%	30,828	75.10%	84,238	71.69%
Renter Occupied	623	13.29%	10,219	24.90%	33,259	28.31%
Income						
Average Household Income	\$92,072		\$104,133		\$100,224	
Median Household Income	\$74,068		\$79,154		\$75,032	

Source: Claritas, Inc.